

Thank you for purchasing this product. Please read the instruction carefully for details.



### ATTENTION

1. Upon installation make sure the environment is clean as it may affect its precision.
2. We shall not be held liable and shall not accept any liability, obligation or responsibility whatsoever for any damage on the item during assembly and disassembly.

## 1

### PARTS INCLUDED

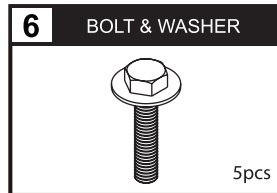
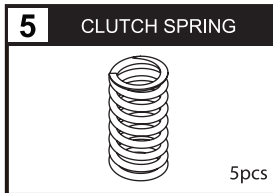
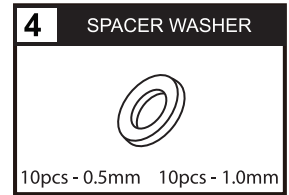
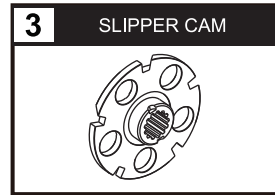
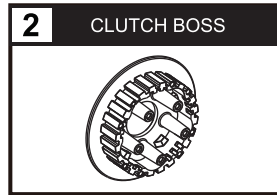
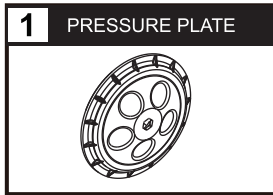

## 2

### INSTALLATION DIAGRAM

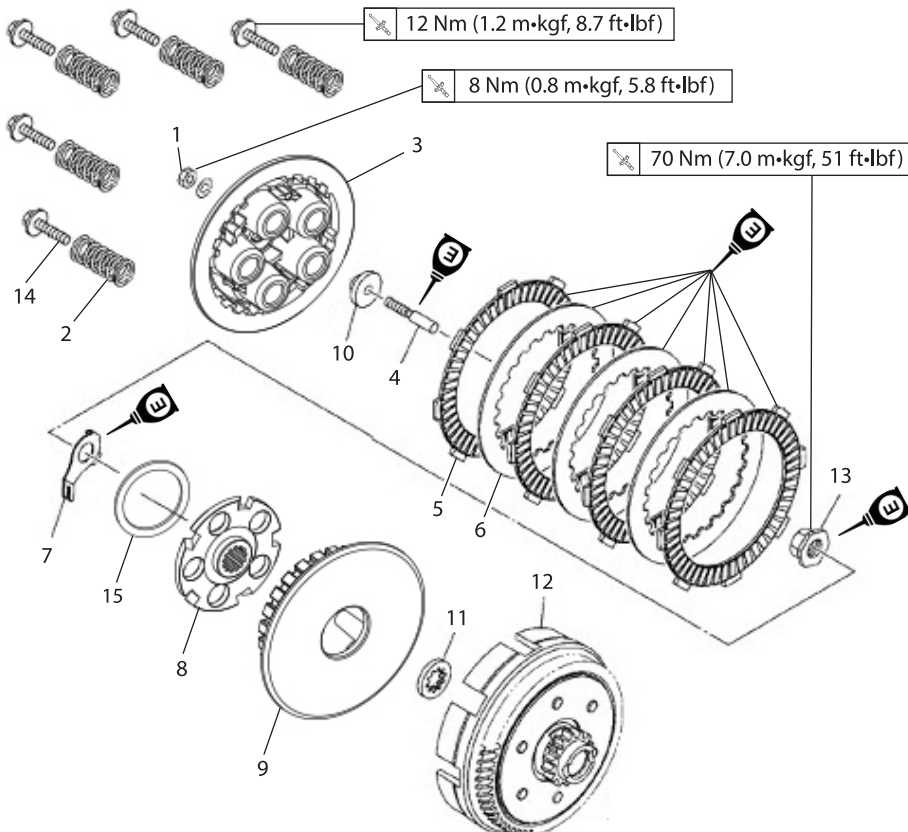

#### Tuning Tips:

1. Install additional washers to Pos.14 for increased clutch slip.
2. Additional spacer washers will make the slipper cam slip more easily. Refer next page for more info.



: To apply or smear with engine oil

S/NO	DESCRIPTION
1.	LOCKNUT
2.	CLUTCH SPRING
3.	PRESSURE PLATE
4.	SHORT CLUTCH PUSH ROD
5.	FRICTION PLATE/ CLUTCH DISC
6.	CLUTCH PLATE
7.	LOCK WASHER
8.	SLIPPER CAM
9.	CLUTCH BOSS
10.	CLUTCH PUSH ROD HOLDER
11.	THRUST WASHER
12.	CLUTCH HOUSING
13.	CLUTCH BOSS NUT
14.	BOLT & WASHER
15.	SLIPPER CAM WASHER

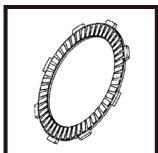

Recommended to use UMA Racing Carbon Clutch Disc/ Friction Plate for best results and compatability.

Y15ZR Carbon Clutch Disc/ Friction Plate : 02C00900



Figure 1

**Slipper Cam**

Slipper cam will slip up to disengage drive from engine momentarily to mitigate high back torque from engine and return to position when ideal back torque is met.

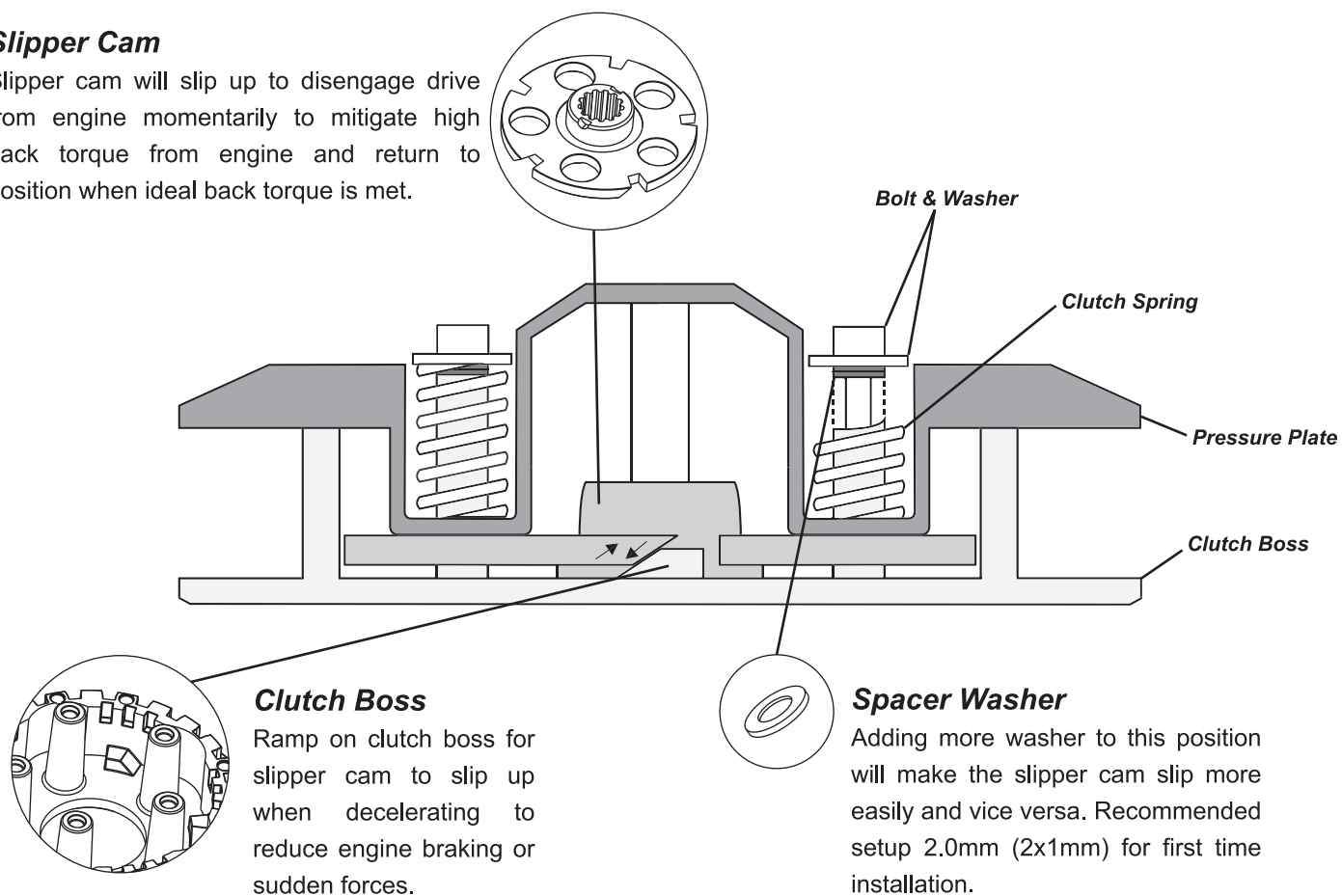

*\*Included 10pcs 0.5mm & 10pcs 1mm spacer*

Figure 2

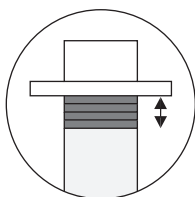
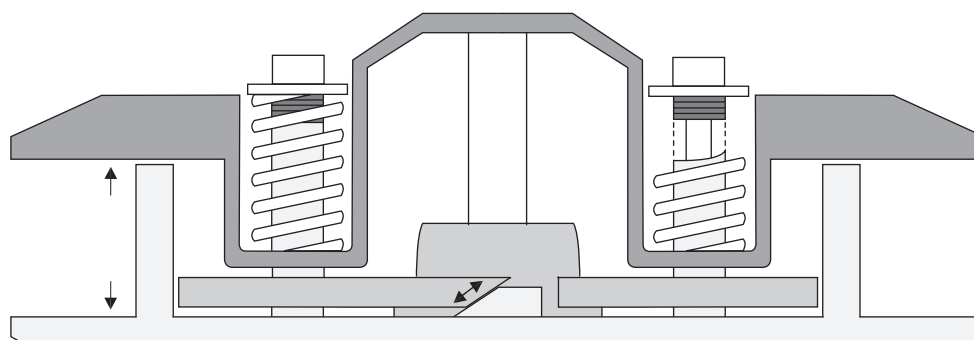

Increased thickness by adding spacer washer forces the pressure plate and clutch boss apart for the slipper cam to slip easily and more. Increase or decrease the thickness to your liking. Movement highlighted in blue arrows.