

Please read this instruction manual carefully prior to installation. Keep this manual readily accessible for future reference.



ATTENTION

1. Upon installation, please ensure that your surrounding environment is clean, as it may affect its precision.
2. We shall not be held liable and shall not accept any liability, obligation, or responsibility whatsoever for any damage to the item during the course of assembly and/or disassembly.
3. Please seek professional assistance or advice if you are unclear about the instructions or have any doubts regarding the procedures.

1 AIR FILTER DUAL KIT SERIES (DUAL LAYER FILTER)

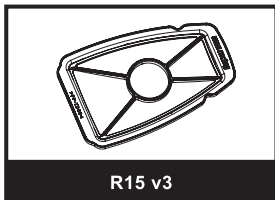
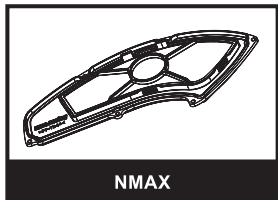
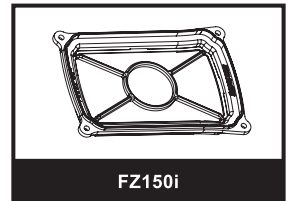
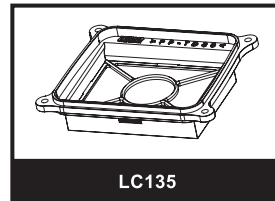
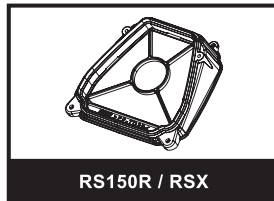
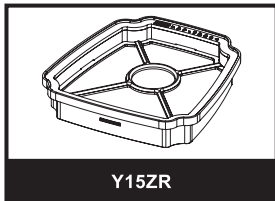

2 AIR FILTER KIT SERIES (SINGLE LAYER FILTER)

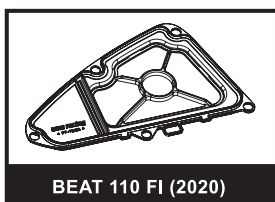
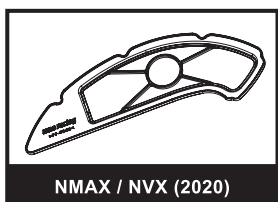
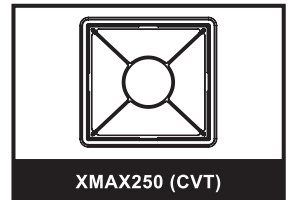
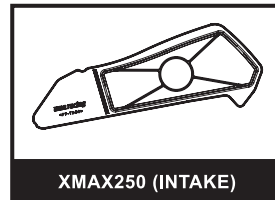
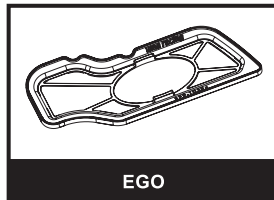
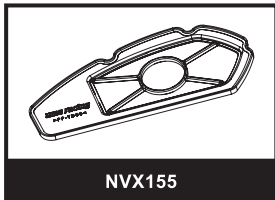
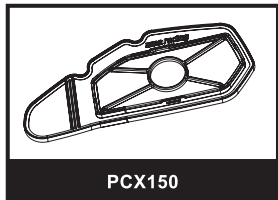

3 PARTS BREAKDOWN

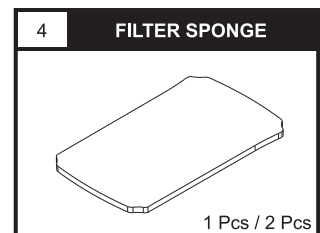
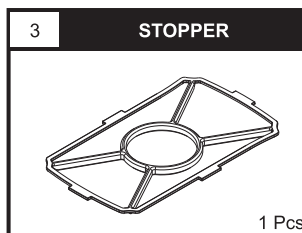
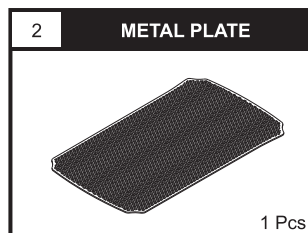
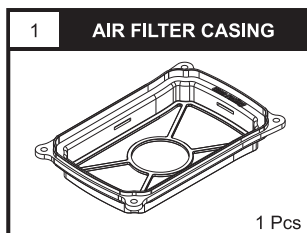

NOTE: ONLY DUAL KIT SERIES AIR FILTER COMES WITH TWO (2) PIECES OF FILTER SPONGE.

Diagram above is only for illustration purposes. The drawings may vary based on the model purchased. If there are missing parts, please contact the seller/vendor or return the item.

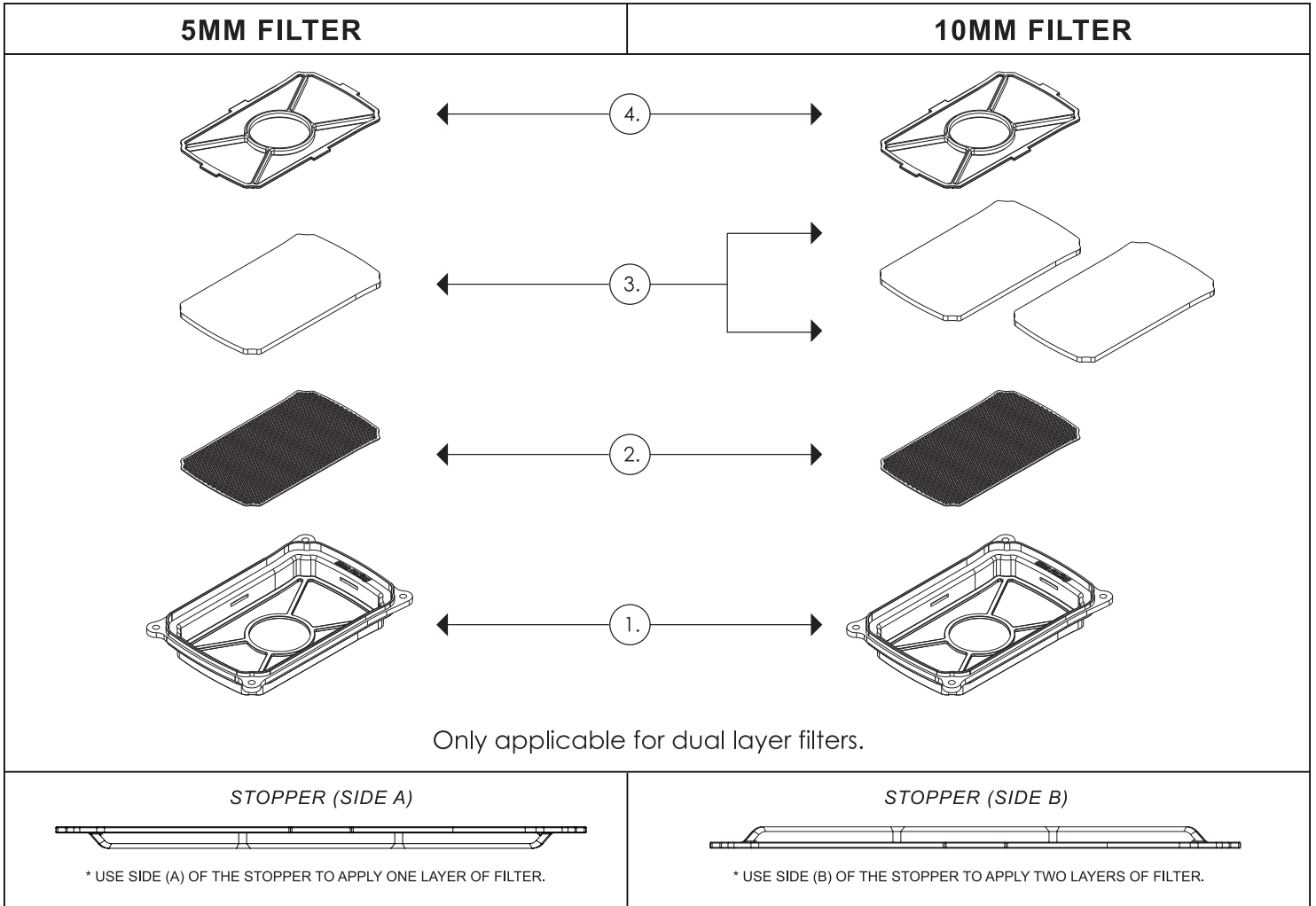

Air filters for the NMAX, BELANG, and R15 models do not require you to flip the stopper. There are two slots available to fit either one or two filter sponges.

AIR FILTER PERIODIC MAINTENANCE CHECKLIST	ODOMETER READING (km)				
	500	2,000	4,000	6,000	8,000
Tick or mark the appropriate field for record keeping purposes.	<input type="checkbox"/>	<input type="checkbox"/>	<input type="checkbox"/>	<input type="checkbox"/>	<input type="checkbox"/>

1. It is recommended that first-time maintenance be performed at 500 km and then every 2,000 km thereafter.
2. The sponge filters are washable. Wash with clean water or with soap.
3. Washed filters should be air dried properly before being reinstalled back onto the motorcycle.
4. Seek professional help if you are experiencing difficulties.

