



- Thank you for purchasing Y15 clutch.
- Before installation, please read the instruction carefully. We recommend that you store the instruction sheet in a safe place for future reference.

## ⚠ NOTICE

- To install, follow the steps as described in the manual. Any damages caused by not following directions voids warranty.
- Correct tools must be used for installation.
- Do not modify any parts unless specifically stated in the instruction manual.
- Interior controller maintenance should be performed by a professional only.





## Ⓞ SYMBOL NOTE:

**NOTE** Read this information carefully regarding the essential features.

☞ To smear engine oil before install.

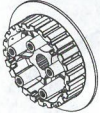
**⚠ CAUTION!** Some processes must be followed to avoid the damage to the vehicle.

## 1 ACCESSORY

<b>1</b> Clutch boss X1	<b>2</b> Pressure plate X1	<b>3</b> Clutch spring X5	<b>4</b> Screw with washer X5	<b>5</b> Lock washer X1
				

**NOTE** Please contact the local distributor if the items you open are not the same, as the above-listed one.

## 2 INSTALLATION INSTRUCTIONS

1. Primary driven gear comp
2. Plate
3. Clutch boss
4. Friction plate 1
5. Friction plate 2
6. Clutch plate
7. Pressure plate 1
8. Clutch spring
9. Screw with washer
10. Push plate
11. Push rod
12. Washer
13. Nut
14. Lock washer
15. Nut

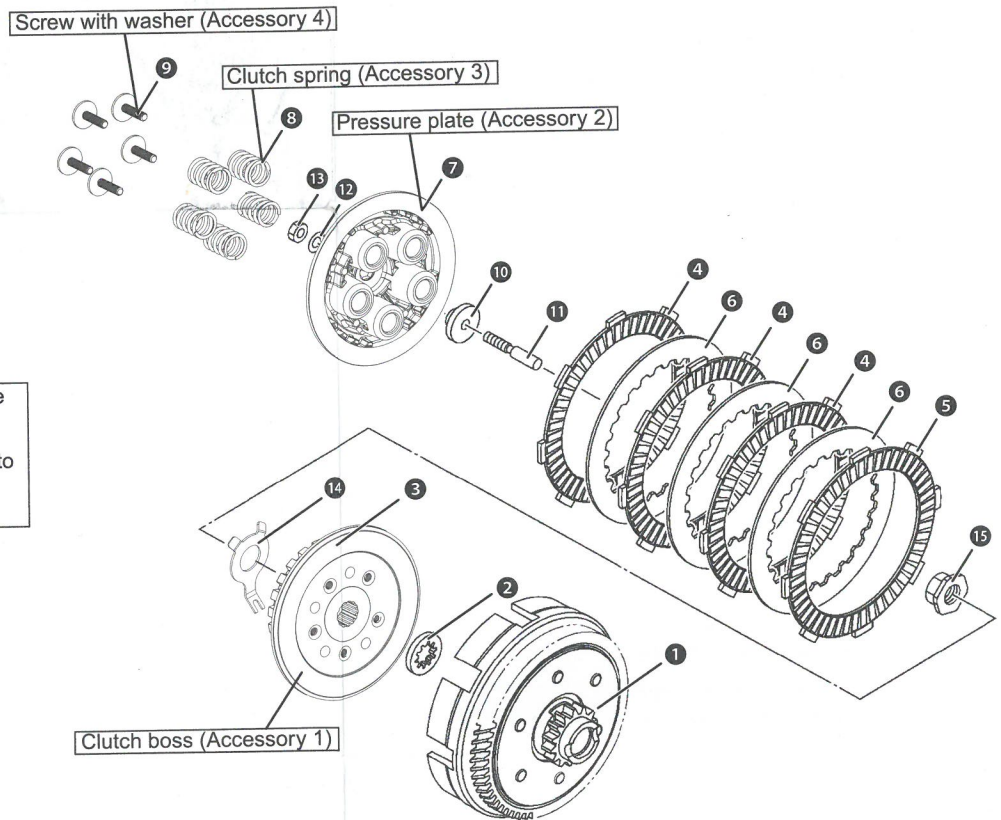

**NOTE** Please do according to figure in order. Make sure to disassemble the parts in opposite order. Please refer to the illustration for installation sequence.